



How to fill in ordering code

Step 1: clamping force



20 = 20 kN

40 = 40 kN

60 = 60 kN

100 = 100 kN

160 = 160 kN

250 = 250 kN

Step 2: T-slot size

ELY20
18
22

ELY40
18
22

ELY60
22
28

T-SLOT
ACC. TO DIN650
18 H8
22 H8
28 H8
36 H8

ELY100
22
28

ELY160
28
36

ELY250
28
36

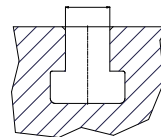

Step 3: clamping height

ELY20
25 (RANGE 20-25 mm)
30 (RANGE 25-30 mm)
35 (RANGE 30-35 mm)
40 (RANGE 35-40 mm)

ELY40
30 (RANGE 25-30 mm)
35 (RANGE 30-35 mm)
40 (RANGE 35-40 mm)
45 (RANGE 40-45 mm)
50 (RANGE 45-50 mm)

ELY60
40 (RANGE 35-40 mm)
45 (RANGE 40-45 mm)
50 (RANGE 45-50 mm)
55 (RANGE 50-55 mm)
60 (RANGE 55-60 mm)

ELY100
40 (RANGE 35-40 mm)
45 (RANGE 40-45 mm)
50 (RANGE 45-50 mm)
55 (RANGE 50-55 mm)
60 (RANGE 55-60 mm)

ELY160
50 (RANGE 45-50 mm)
55 (RANGE 50-55 mm)
60 (RANGE 55-60 mm)
65 (RANGE 60-65 mm)
70 (RANGE 65-70 mm)

ELY250
60 (RANGE 55-60 mm)
65 (RANGE 60-65 mm)
70 (RANGE 65-70 mm)
75 (RANGE 70-75 mm)
80 (RANGE 75-80 mm)

3 mm
2 mm

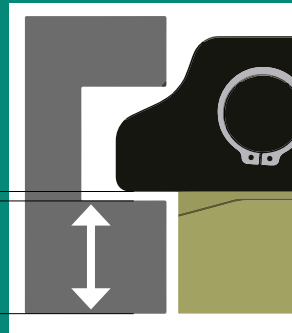

- Single acting cylinder
- Available in 20, 40, 60, 100, 160 and 250 kN
- Fits in any T-slot according to DIN 650

- Working pressure 350 bar
- Temperature range 5 °C - 200 °C

SELECTION CHART

EAS TYPE	Clamping Force [kn]	Operating Pressure [bar]	Cylinder Weight [kg]	Oil Volume [cm ³]	Dimensions in [mm]													
					(T) (T-slot size)	(H) (backplate)	G1	G2	R	S	J	K	L	M	O	P	a	b
					ELY 20	20	350	2,7	5,7	18 or 22	20 to 40	T+38	T+48	55	62	22	15	95
ELY 40	40	350	4,5	10,6	18 or 22	25 to 50	T+47.5	T+58	70	77	22	15	110	40	30	G1/4"	2	3
ELY 60	60	350	7,4	17,0	22 or 28	35 to 60	T+58	T+68	80	87	22	15	130	40	30	G1/4"	2	3
ELY 100	100	350	12,2	27,1	22 or 28	35 to 60	T+73	T+83	90	97	25	18	160	50	40	G1/4"	2	3
ELY 160	160	350	21,5	42,4	28 or 36	45 to 70	T+93	T+103	110	120	25	18	193	50	40	G1/4"	2	3
ELY 250	250	350	39,7	66,3	28 or 36	55 to 80	T+118	T+128	130	140	30	22	243	70	40	G1/4"	2	3

