

SECTION Z-Z

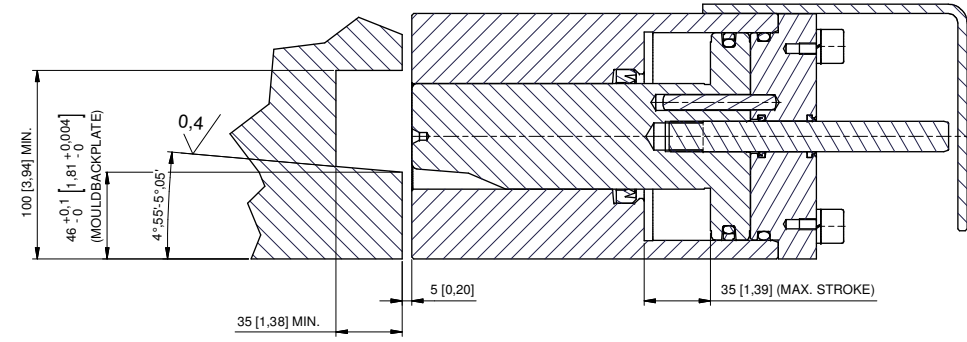

Parts List			
ITEM	QTY	PART NUMBER	DESCRIPTION
1	1	WMD2010-RH-.984-RH-3.346 (0,75)	BASE WMD 2010
2	1	MOD2010-77V	SEAL KIT 200kN
3	1	MOD2010-88	PARTS PROX. SWITCHES
4	1	MOD2010-99	COMM. PARTS 200kN
5	4	B1006-006V	TERMINAL PLUG

TOLERANCES ON DIMENSIONS UNLESS SPECIFIED ± MM[inch]					TOL. ON ANGLES UNLESS SPEC.	TOL. ON RADII UNLESS SPEC. ± MM[inch]				
SIZE	0-5,6 [0,2-24]	6-30 [24-1,18]	30-120 [1,18-4,72]	120-315 [4,72-12,40]	315-1000 [12,40-39,37]	SIZE	0,5-3 [0,2-12]	3-6 [1,2-24]	6-30 [24-1,18]	
TOL.	0,1 [0,04]	0,2 [0,08]	0,3 [0,12]	0,5 [0,2]	0,8 [0,3]	± 1'	TOL.	0,2 [0,08]	0,5 [0,2]	1 [0,4]
SPECIFICATIONS						DIMENSIONS IN BRACKETS ARE IN [INCH]				
NO CHANGE, NO PROGRESS						FINISH UNLESS SPECIFIED				
						3,2 $\sqrt{Ra\mu m}$ [Raμ]				
WEIGHT: ± 38,724 kg						SCALE 1 : 2				
ALL ANGULAR DIMENSIONS ARE ± 1' UNLESS SPECIFIED						DESCRIPTION				
						MOULDCLAMP				
						WMD2010-RH-.98-RH-3,35				
GROUP	C.		DO NOT	DR.	DATE	DRAWING NO.				
TECH.	M.		SCALE	breep	8-1-2016	Rev				
CODES			DRAWING	CH.	DATE	WMD2010-RH-.98-RH-3,35				
						9/02				
						A2				

THIS PRINT AND INFORMATION THEREIN IS CONFIDENTIAL AND PROPRIETARY AND IS THE PROPERTY OF EAS. IT IS NOT TO BE COPIED OR REPRODUCED WITHOUT WRITTEN PERMISSION OF EAS.