

ERC Rocker Clamp

How to fill in ordering code

ERC	Standard			Optional			
	Clamping force	Clampheight	T-slot	Support roller	Proximity sensor	Air cylinder	Check valve
ERC	T...

Clamping force

- 20 = 20 kN
- 40 = 40 kN
- 60 = 60 kN
- 100 = 100 kN
- 160 = 160 kN
- 250 = 250 kN

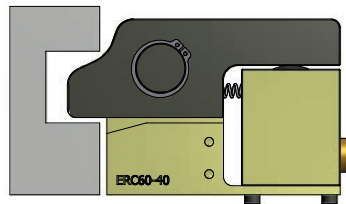

Optional - Support roller

Fill in 'S'



Optional - Proximity sensor

Fill in 'P'



Clampheight

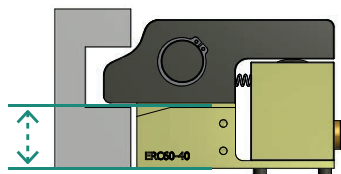

ERC20 (range)	ERC40 (range)	ERC60 (range)
25 = (20-25 mm)	30 = (25-30 mm)	40 = (35-40 mm)
30 = (25-30 mm)	35 = (30-35 mm)	45 = (40-45 mm)
35 = (30-35 mm)	40 = (35-40 mm)	50 = (45-50 mm)
40 = (35-40 mm)	45 = (40-45 mm)	55 = (50-55 mm)
	50 = (45-50 mm)	60 = (55-60 mm)
ERC100 (range)	ERC160 (range)	ERC250 (range)
40 = (35-40 mm)	50 = (45-50 mm)	60 = (55-60 mm)
45 = (40-45 mm)	55 = (50-55 mm)	65 = (60-65 mm)
50 = (45-50 mm)	60 = (60-65 mm)	70 = (65-70 mm)
55 = (50-55 mm)	65 = (60-65 mm)	75 = (70-75 mm)
60 = (55-60 mm)	70 = (65-70 mm)	80 = (75-80 mm)

Optional - Air cylinder

Fill in 'M'

Available on 20, 40, 60 & 100 models



Optional - Check valve

Fill in 'V'



T-slot size

ERC20 T18 or T22	ERC40 T18 or T22	ERC60 T22 or T28
ERC100 T22 or T28	ERC160 T28 or T36	ERC250 T28 or T36

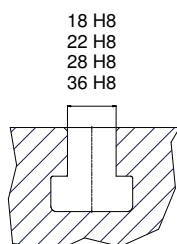

Example

For example:

ERC6050T220000 or ERC6050T22SP00 or ERC6050T22SPMV

ERC	Standard			Optional			
	Clamping force	Clamp-height	T-slot	Support roller	Proximity sensor	Air cylinder	Check valve
ERC	60	50	T22	0	0	0	0
or							
ERC	60	50	T22	S	P	0	0
or							
ERC	60	50	T22	S	P	M	V

EASC6002LUK0216